



# MONKEY KING III SPECIFICATION

WLC03/20/SW/8S3/20° /YY/347/PHO

Classic architectural lines, and a downlight or uplight or both select 5CCT select as any of your preferred mood. Universal dimming driver (0-10V); 50,000-Hour LED lifespan; Sleek, contemporary, architectural-grade design; LED cylinders that look as great as they perform.

## Product data

---

### General Information

Light source replaceable	NO
Number of gear units	1
Driver/power unit/transformer	Power supply unit
Driver included	Yes
Optic type	Symmetrical
Optical cover/lens type	-
Luminaire light beam spread	20° /40° /80°
Sensor socket	-
Cable length	Cable 0.3 m without plug
Protection class IEC	-
Certifications	cETLus/DLC 5.1 Standard/Premium
Lifetime (hour)	50,000H
EU RoHS compliant	Yes

Light source engine type	LED
--------------------------	-----

## Operating and Electrical

Input voltage	100-347V
Input frequency	50/60Hz
Current	0.2A
THD	<20%
Power factor (min)	0.9

## Mechanical and Housing

Housing material	Aluminum
Reflector material	-
Optical cover/lens material	Glass
Optical cover/lens finish	Clear/Frosted
Product dimensions mm	297*115*130.7
Product dimensions (inch)	11.69*4.53*5.15
Product color	Black/White/Bronze

## Approval and Application

Ingress protection code	IP65
Mech.impact protection code	

## Initial Performance (IEC Compliant)

Light output	1050lm-10W/2100lm-20W
Luminous flux tolerance	+/- 10%
Efficacy	20W: 105lm/w; 36W: 120lm/w
Init.Corr.Color Temperature	3CCT
Init.Color Rendering Index	80
Initial input power	10W/20W
Power consumption tolerance	+/- 10%

## Application Conditions

Ambient temperature range	-40 to +50°C
Dimming	0-10V

## Logistical Data

Order product name	WLC03/20/SW/8S3/20° /YY/347/PHO
Net weight (piece)	-
Gross weight (piece)	-
Packaging dimensions (mm)	-
Packaging dimensions (inch)	-
Packaging unit (piece)	-

Volumen (m <sup>3</sup> )	-
Volumen (ft <sup>3</sup> )	-

## Application

Security Lighting

Pathway Lighting

Entryway Lighting

## Light Distribution & Spectrum

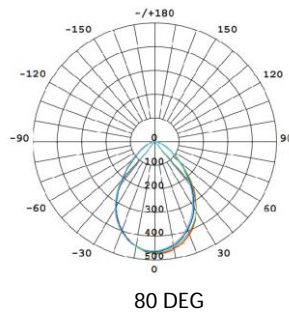
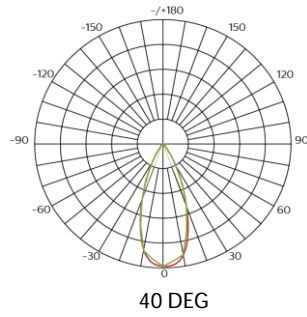
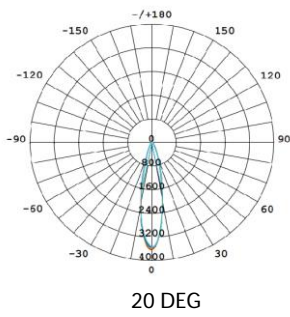

## Dimensional drawing

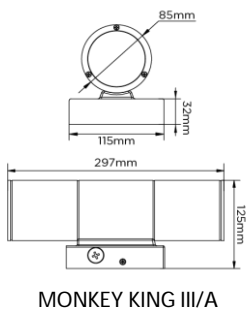

Plusrite does not give any representation or warranty as to the accuracy or completeness of the information included herein and shall not be liable for any action in reliance thereon. The information presented in this document is not intended as any commercial offer and does not form part of any quotation or contract, unless otherwise agreed by Plusrite. Plusrite is registered.